

130 - 160mm Stud To Glass Door Frame - Anodised (Model: G.DK.SG.SA.002)

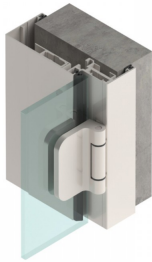

This stud/wall to glass door aluminium door frame with integrated hinge & receiver profile is suitable for glass thicknesses of 8-10mm.

- Recommended max door height- 2400mm.
- Above a height of 2200 mm, it is recommended to use 3 hinges.
- Suitable when the stud/wall thickness is 130-160mm.
- This profile is designed in this shape to fit securely into a reveal covering opening edge like an architrave. The design creates a rebate for the glass door to reduce both noise and air movement.
- Installing of the hinges requires no drilling or milling and they can be adjusted in seconds.

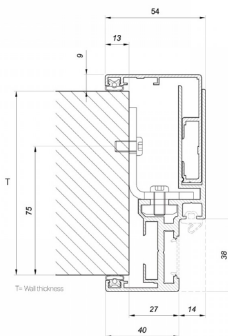

Attributes:

Product Code: G.DK.SG.SA.002

Unit Of Sale: 6 Metres